

Sanctuary

MODERN GREEN HOMES

ISSUE
67

SMALL PROJECTS
SPECIAL

Top tips for a great smaller home; growing gorgeous flowers; the how and why of secondary dwellings; slab edge insulation

Little wins

Celebrating simpler,
smaller, smarter design



PUBLISHED BY **renew.**
WINTER 2024 • AU/NZ \$13.95
SANCTUARY.RENEW.ORG.AU

ISSN 1833-1416



9 771833 141017

WIN

A Reclaim hot water heat pump valued at \$6,000, provided by Earthworker Energy Manufacturing Cooperative

Offer open to Australian residents. Details page 91

HOUSE PROFILE
Chapel Hill, QLD

WORDS
Emma Scragg

PHOTOGRAPHY
Andy Macpherson



AT A GLANCE

- *35m² pavilion provides roofed outdoor living plus one multipurpose room*
- *Structure of reclaimed timber*
- *Designed to complement and enhance existing garden*



Garden gem

This Brisbane couple opted for a small, carefully crafted pavilion to enhance their enjoyment of their beloved garden.

Right The new structure creates a buffer between the main house and the neighbouring development, and looks back to the house through frangipanis and an understorey of groundcovers, bushes, grasses and kitchen herbs.



For over 20 years, Di and Mark have enjoyed the home they built in Brisbane's Chapel Hill, nestled into the garden that Di has transformed from bare clay to subtropical lushness. Recently, however, a new development across the street has impacted on their piece of paradise. A rethink of their own home and garden was needed. Architect Matt Kennedy of Arcke helped them hone their brief and fit it to their modest budget: they wanted a place to be immersed in and enjoy their garden in a new way, and a new multipurpose interior space that's separate from their existing house.

"The house had always suffered from external living spaces without any generosity," says Matt. The original pergola overheated under its polycarbonate roof and its lattice, designed to screen a glary roof next door, restricted views, light and breezes. "It was hot, a sauna," recalls Di. Matt saw the opportunity to create a more welcoming, useable space within the larger garden, by removing the pergola and constructing a freestanding garden pavilion to manage sight lines to adjacent properties while capturing breezes. He worked closely with landscape architect Sidone Carpenter to

integrate and optimise the green spaces between the built elements, a key design focus of Arcke's work.

The pavilion is elegantly simple, with raw galvanised posts supporting a structure of finely detailed timber: reclaimed spotted gum remilled locally and left to grey naturally over time. Panels of Danpalon polycarbonate to the upper sections soften the harsh sun, particularly from the west, and glow at night when the pavilion is illuminated from within. The structure runs north-south, parallel to the house; the northern end is an open deck beneath a high roof, equipped with a large

ceiling fan. To the south is the new room, a tropical interpretation of a 'snug' that can also become an extension of the deck with the full-width timber-framed door sliding away completely. In its southern wall, a bank of obscure glass casement windows moderates views and breezes while admitting light. Discreet but spacious cupboards tuck under the windows, and overhead, a large, clear pane of glass looks up into the tree canopy.

The placement of the pavilion has created two new garden spaces. The larger garden fills the five-metre-wide space between the two buildings and celebrates Di's beloved frangipanis, with two framing the path to the pavilion. Beneath their fragrant (and deciduous) canopy, the understorey incorporates cuttings collected and propagated by Di, and stepping stones of sandstone she salvaged from the developers across the road after the old house was demolished. "I love recycling things, and it's the most beautiful sandstone," she says. There was a conscious decision not to have a covered link through this garden between the two buildings. "Sure, you'll get wet when it's raining, but that's all part of the experience," says Matt.

The other new garden is a private fernery off the main bedroom, hidden behind the timber batten screen that is the only physical connection between old and new structures. Sandstone steps lead through a portal into this secret garden of ferns, including the iconic tree ferns of the couple's home country, New Zealand.

While Matt convinced Mark and Di to leave their main home untouched, he did sneak an exquisite new bay window into the lounge. Facets of remilled hardwood play off the existing angles of the house, framing views to the new pavilion through the large window and to the pool through a smaller 'archery' slot to the side. Paving was stepped away under the cantilevered concrete seat to bring the garden right up to the house. "It's bloody brilliant," says Mark.

The pavilion has been transformative for Di and Mark, who enjoy it each day for a variety of uses, both separately and together as well as with family and friends. The reimagined garden created by this small project allows them a fuller immersion in the outdoors, with the luxury of forgetting about the world beyond. **S**



Left The enclosed room at the southern end of the pavilion is floored with salvaged and remilled blackbutt. A high window gives lovely glimpses of greenery. **Above** The project included a new bay window to the lounge in the existing house, framing views to the new pavilion.

FLOOR PLAN



LEGEND

- ① Existing house
- ② Pavilion deck
- ③ Pavilion room
- ④ Bench seat
- ⑤ New bay window
- ⑥ Courtyard garden
- ⑦ Screen
- ⑧ Fern garden

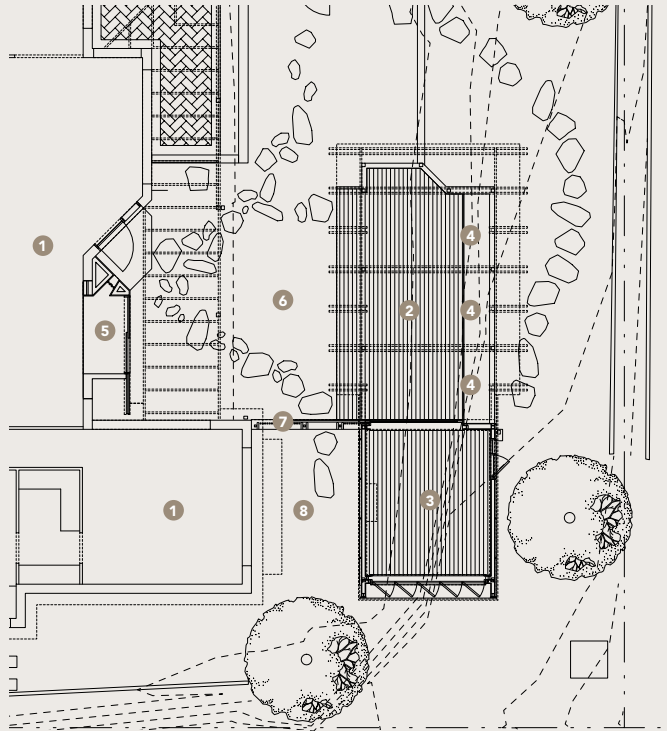

SPECIFICATIONS

DESIGNER

Matt Kennedy, Arcke

BUILDER

Simon Avery,
Avery Building

PROJECT TYPE

New build pavilion

LOCATION

Chapel Hill, QLD
(Turrbal Country)

COST

\$210,000
Completed 2021

SIZE

Pavilion 35m²
Land 880m²

PASSIVE DESIGN, HEATING & COOLING

- Siting, orientation and open structure maximise cooling breezes
- High ceiling lets heat escape
- Eave overhangs to north, east and west for shading
- No glazing penetrations to western wall of enclosed room
- Green canopy and ground cover support cool, shady garden microclimate

ACTIVE HEATING & COOLING

- Fujitsu Designer Series reverse-cycle air conditioner to enclosed room (rarely used)
- Big Ass Fans Haiku ceiling fan to roofed deck

BUILDING MATERIALS

- Raw galvanised steel structural posts
- Reclaimed spotted gum framing joists, bearers, decking, battens and cladding
- Recycled blackbutt flooring to enclosed room
- Roof: 16mm Danpalon Traditional polycarbonate sheet to decked area; galvanised steel sheet to enclosed room
- Insulation to enclosed room: Bradford Gold batts to ceiling (R2.3) and external walls (R1.5)

WINDOWS & GLAZING

- Windows and doors with low-e glass, framed in New Guinea rosewood for stability and durability in the subtropical climate

LIGHTING

- LED wall lights from Artemide
- LED garden lights from Havit Lighting

PAINTS, FINISHES & FLOOR COVERINGS

- Fiddes Hard Wax to blackbutt floorboards
- Cutex Extreme 50 oil to external exposed timber